

ALEX MOORE PARK (Johnsonville)

One senior block, two 18m pitches (J1, J2), three 16m pitches (J3, J4, J5)

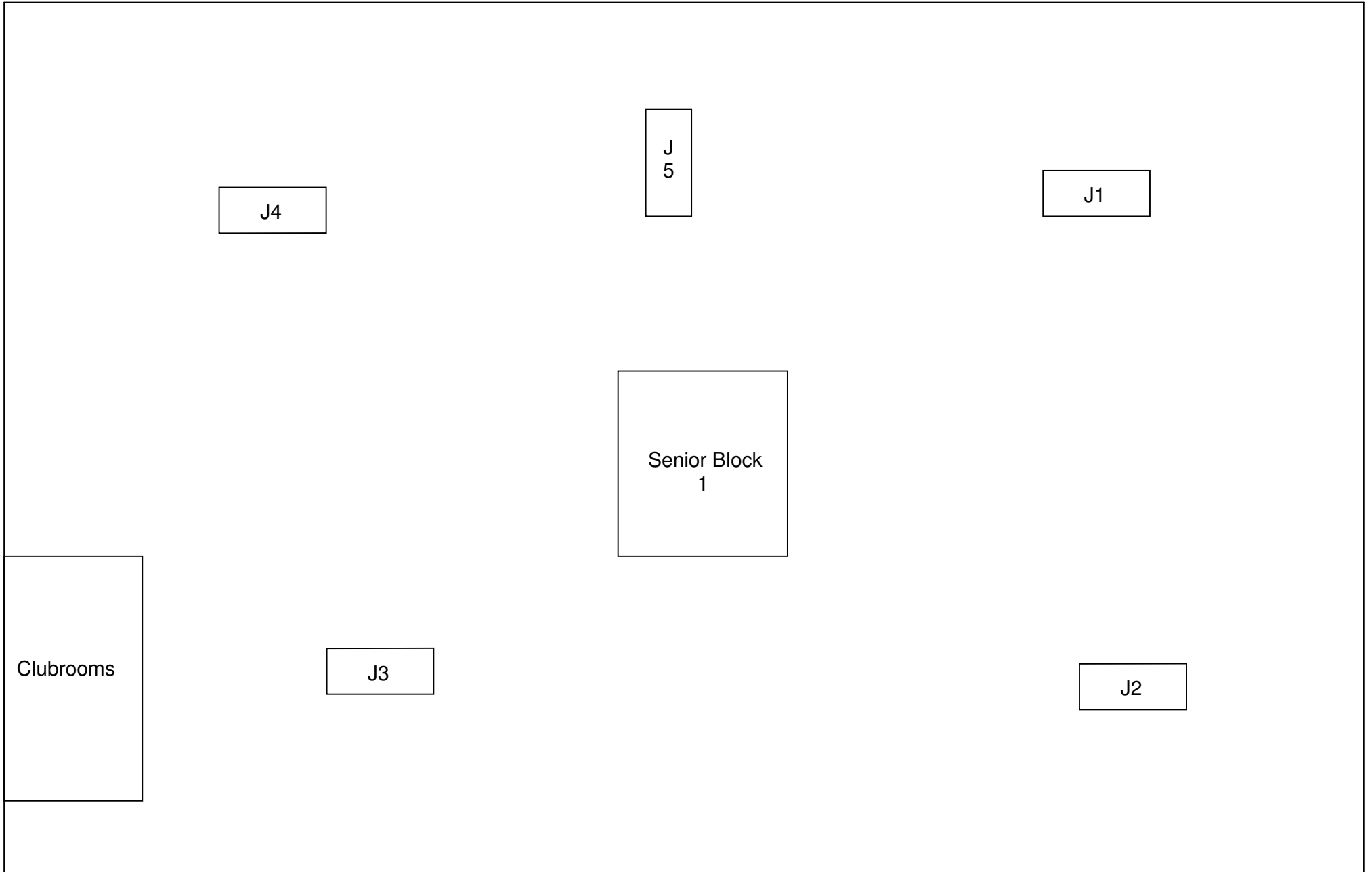

ANDERSON PARK (Wellington City)
One senior block, four 16m pitches (J1, J2, J3, J4)

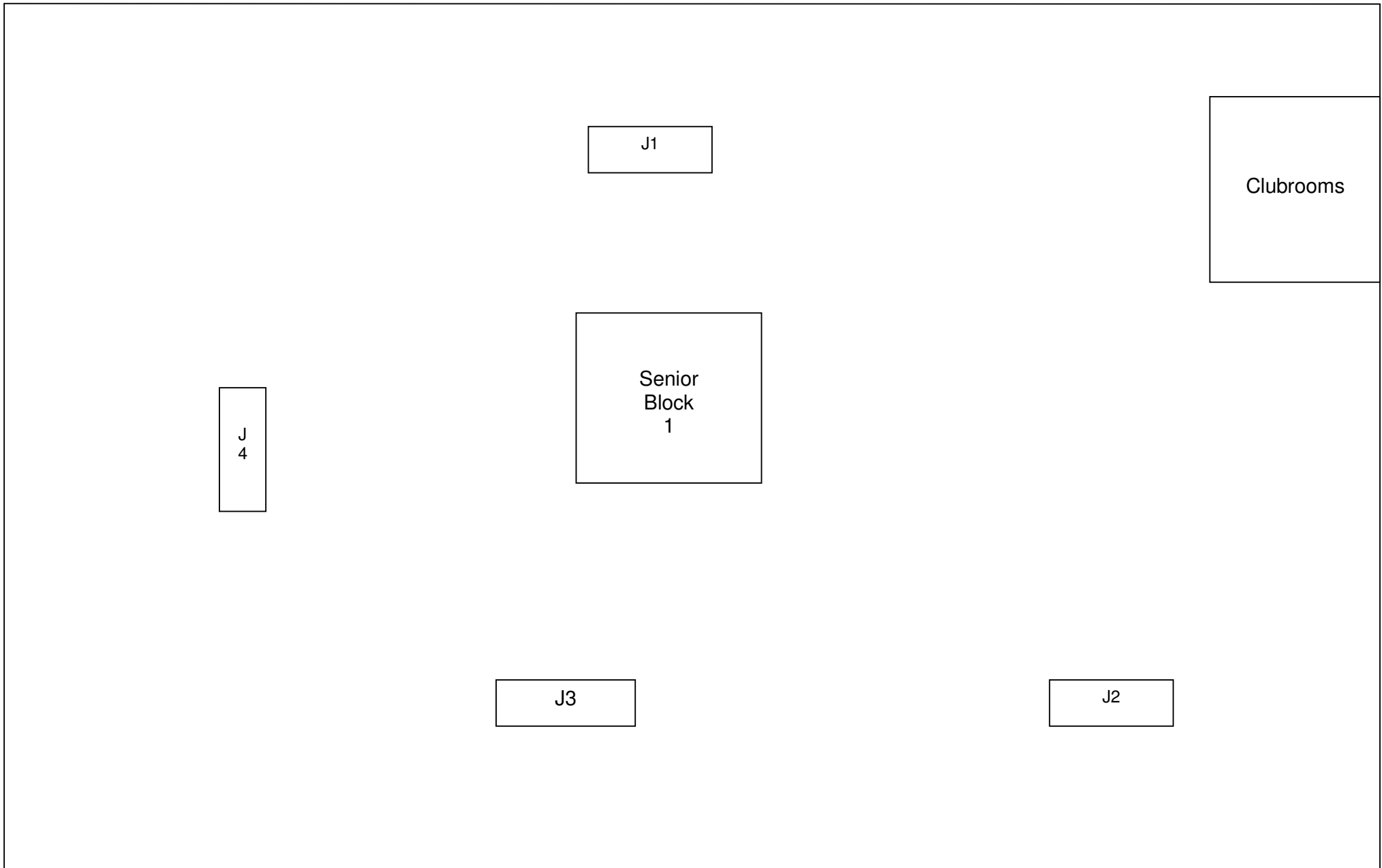

BEN BURN PARK (Karori)

One artificial pitch (A1), one 16m pitch (J1)

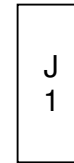
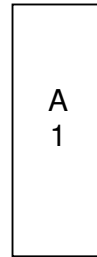

CHURTON PARK (Churton Park)
One artificial pitch (A1)

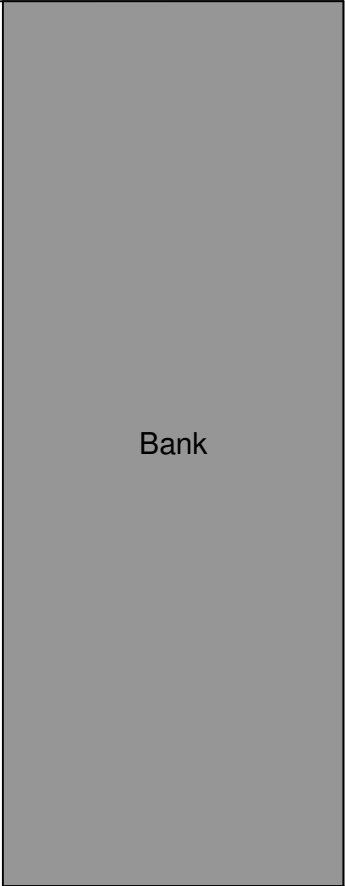
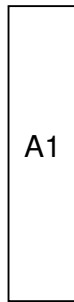

COBHAM PARK (Kilbirnie)

Three senior blocks, three 18m pitches (J1, J2, J3)

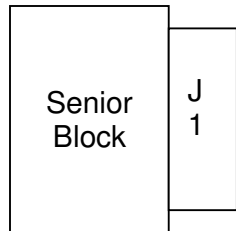
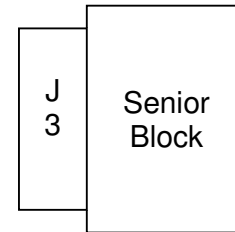
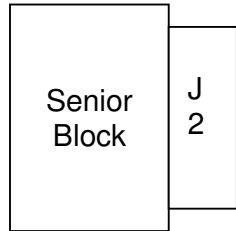

Kemp Street

GRENADA NORTH PARK (Grenada North)

One senior block, two 18m pitches (J1, J2), five artificial pitches (A1, A2, A3, A4, A5)

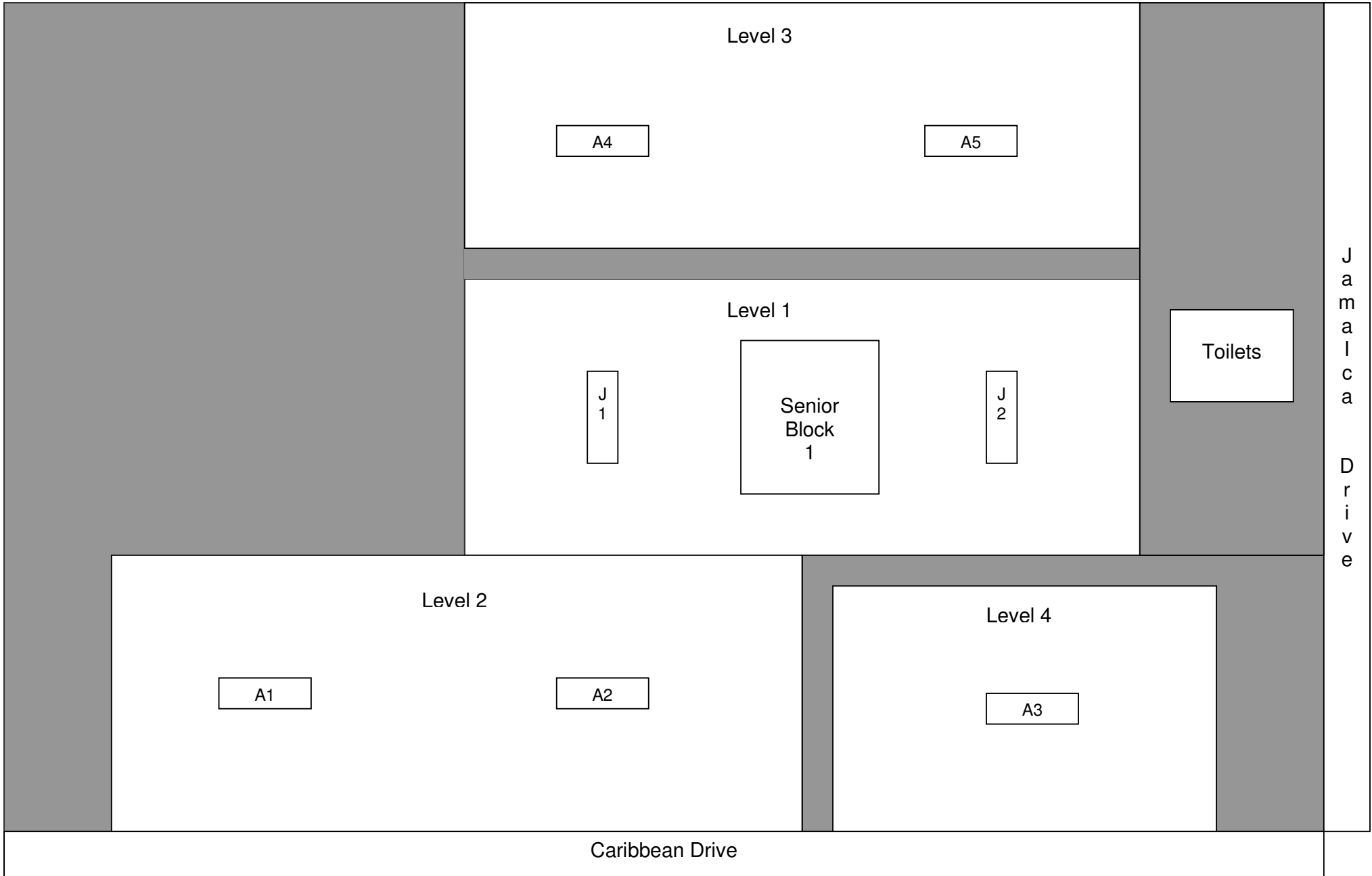

HAPPY VALLEY PARK (Happy Valley)

Two artificial pitches (A1, A2)

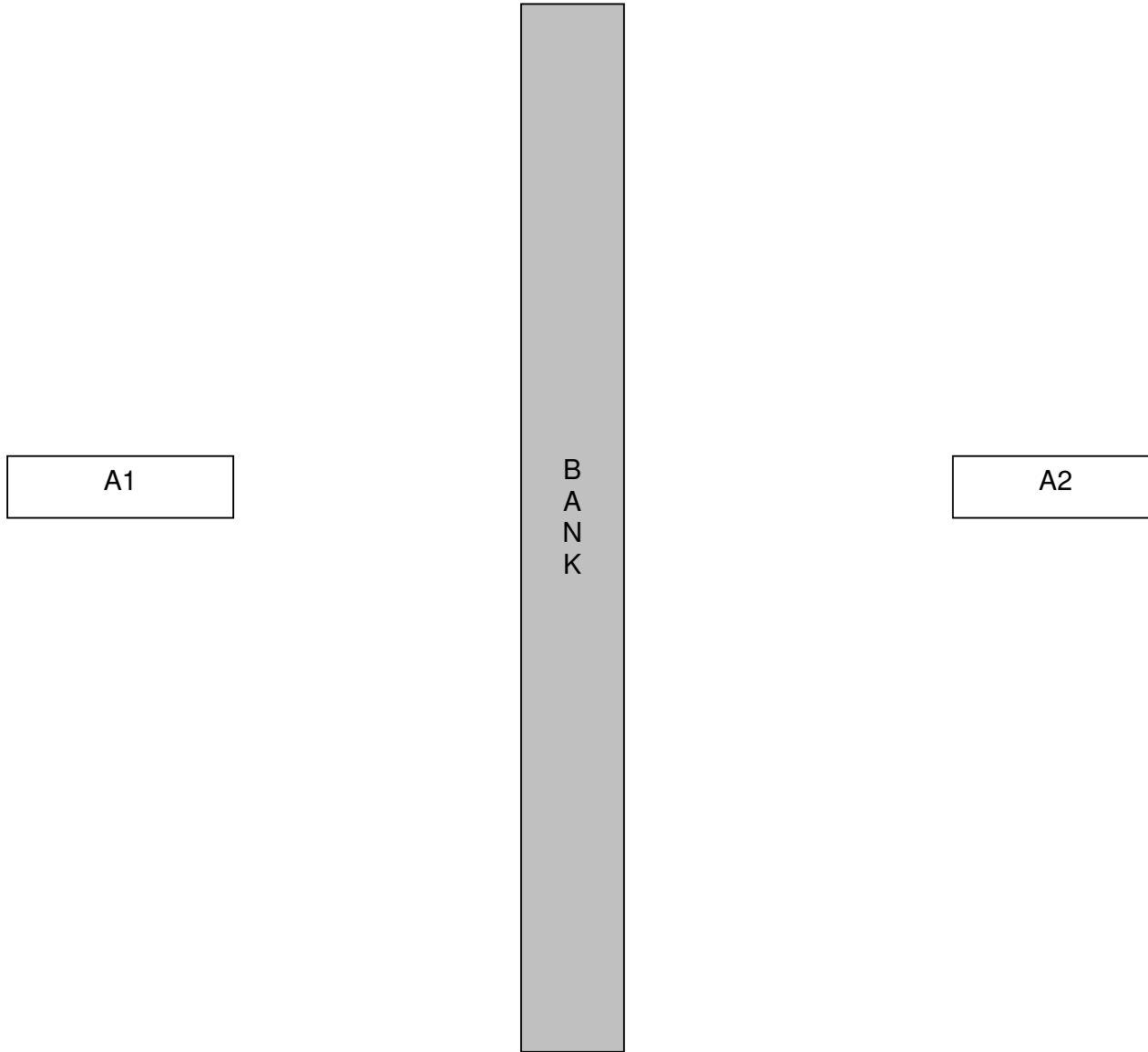

IAN GALLOWAY PARK (Wilton)
Seven artificial pitches (A1, A2, A3, A4, A5, A6, A7)

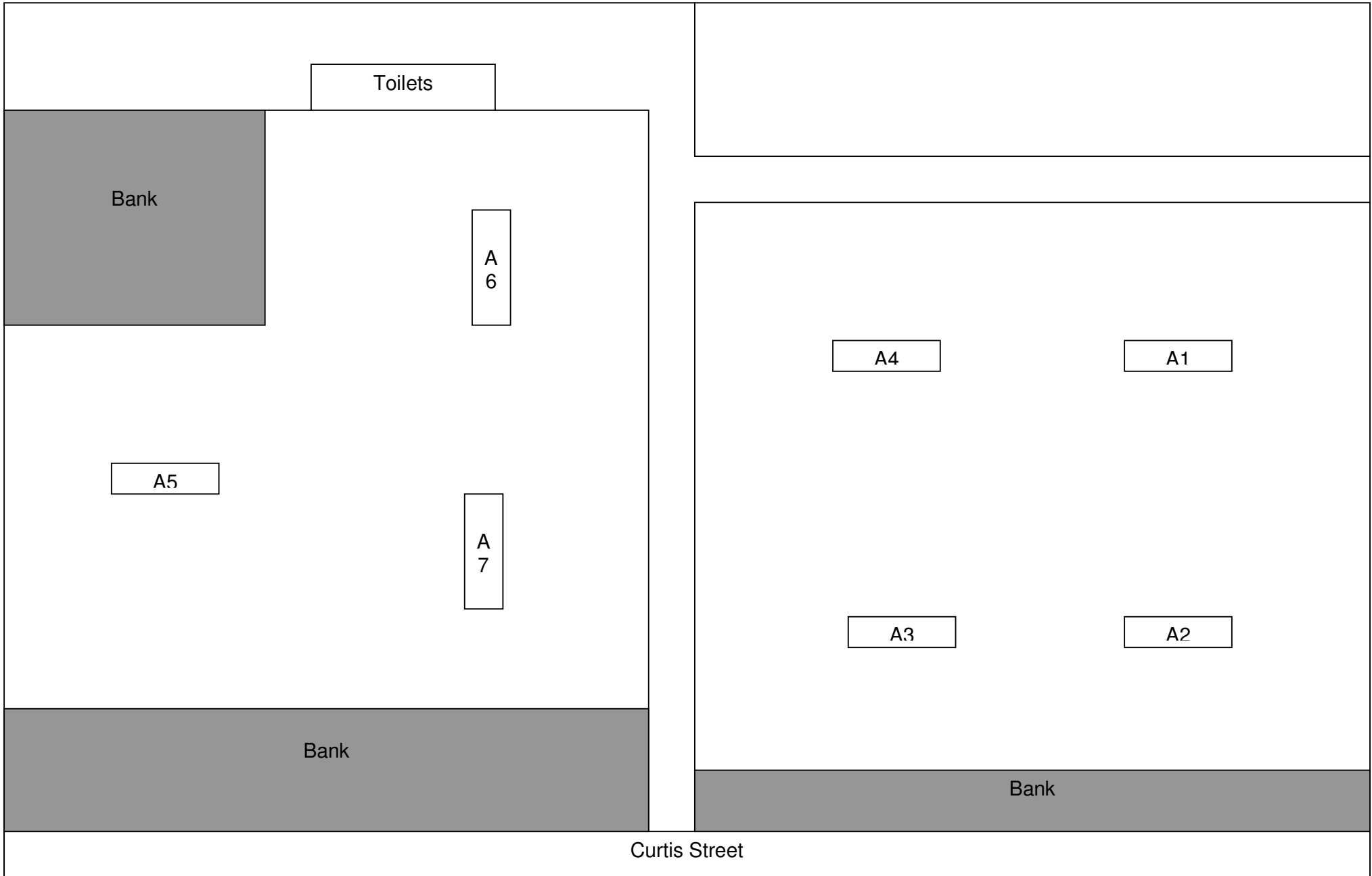

KARORI PARK (KARORI)

Five senior blocks, one full size pitch (J1), two 18m pitches (J2, J3), eight 16m pitches (J4, J5, J6, J7, J8, J9, J10, J11)

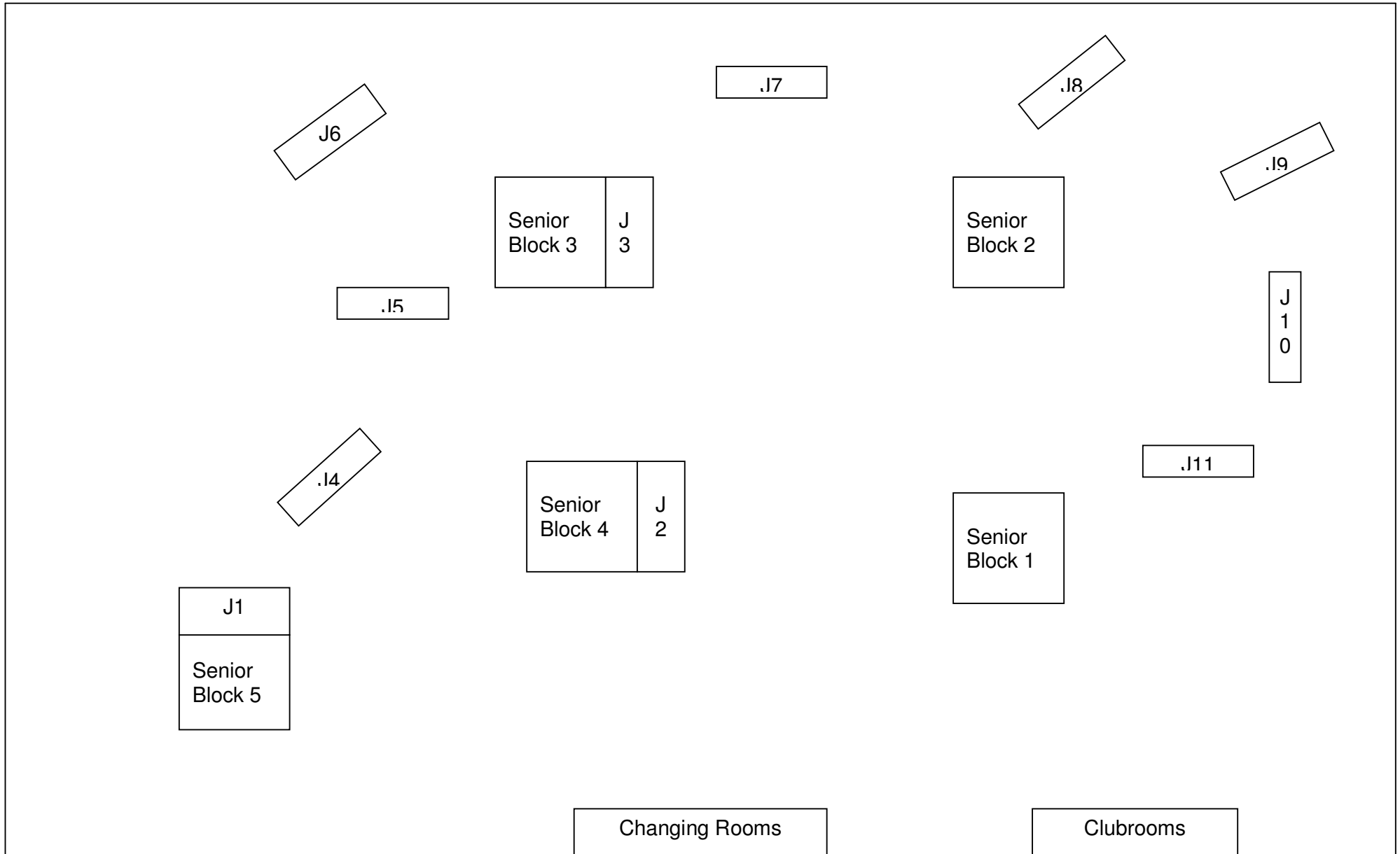

KELBURN PARK (Kelburn)

One senior block, two 18m pitches (J1, J2), two 16m pitches (J3, J4,)

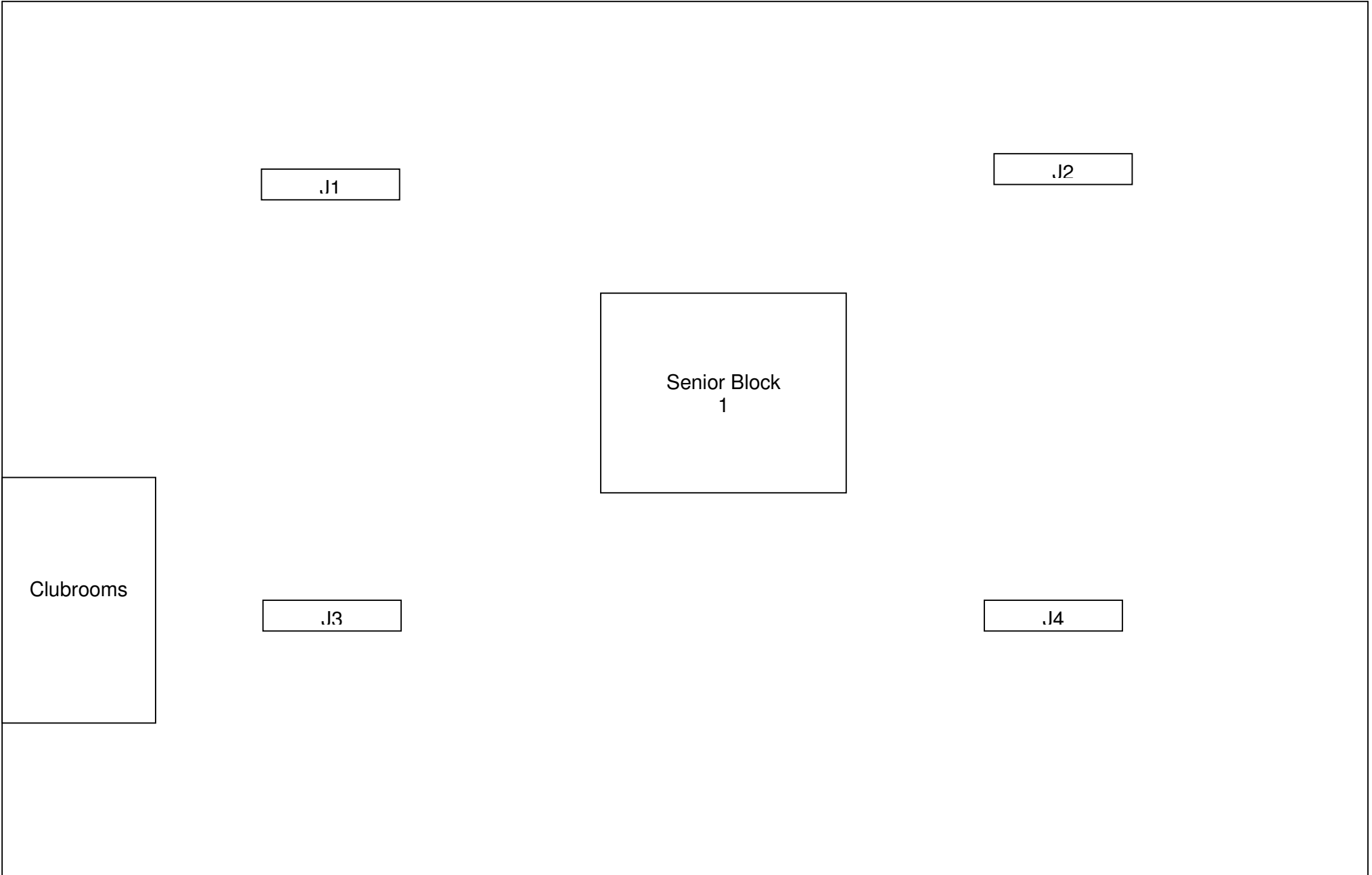

KILBIRNIE PARK (Kilbirnie)

Three senior blocks, one college block, three 16m pitches (J1, J2, J5), two 18 pitch (J3, J4), three artificial pitches (A1, A2, A3)

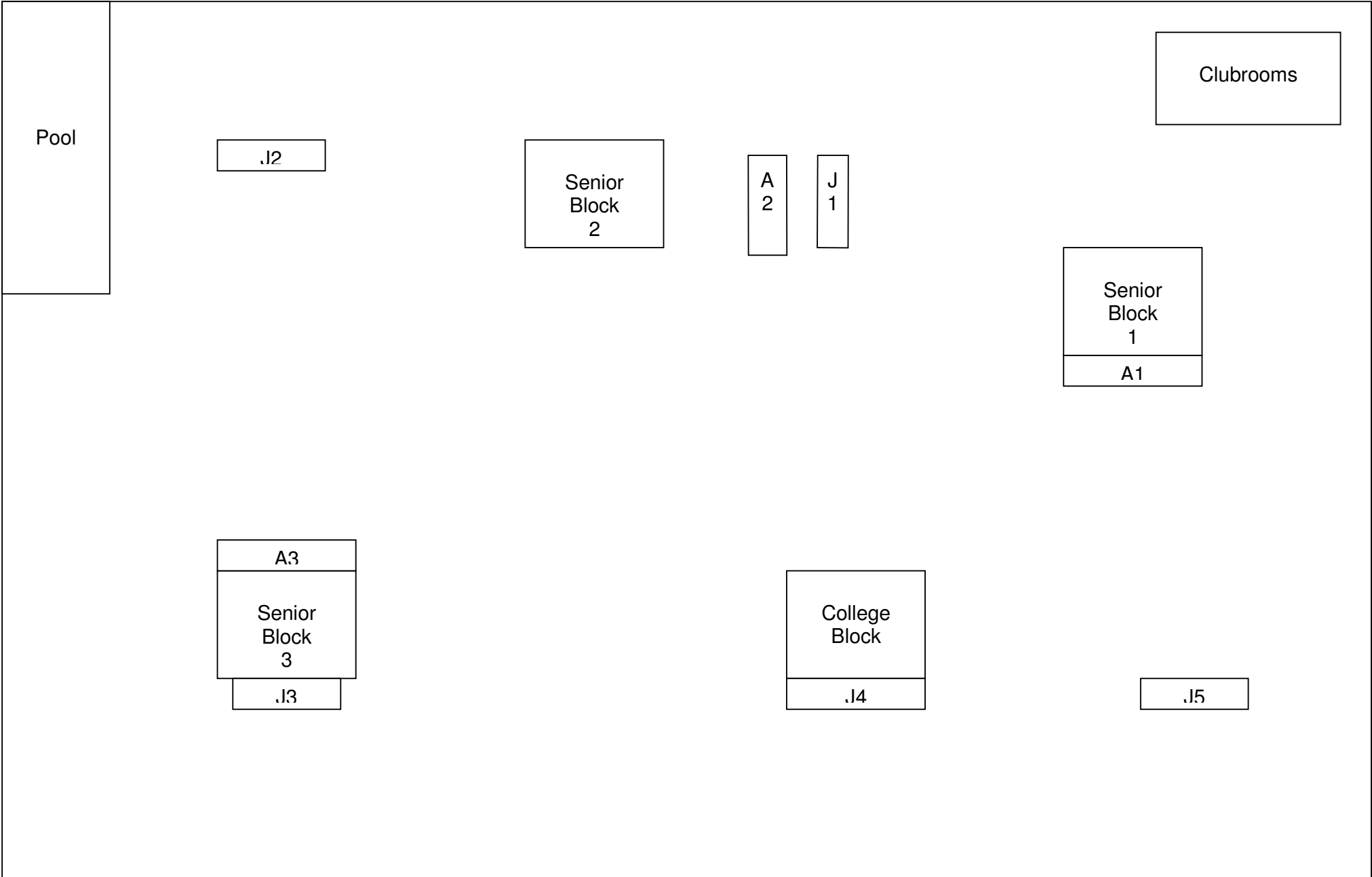

LIARDET STREET PARK (Morningside)

Three artificial pitches (A1, A2, A3), one 18m pitch (J3)

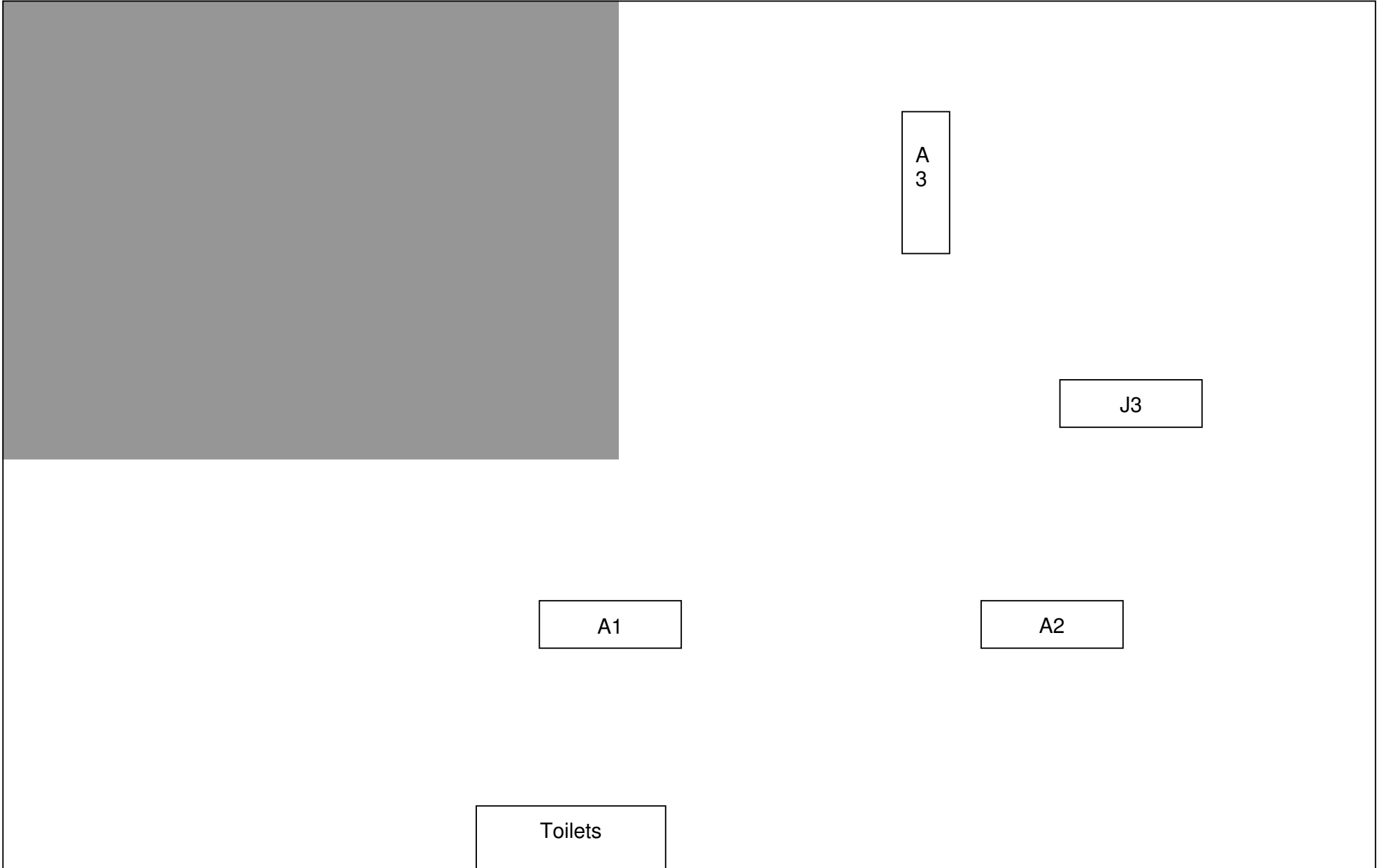

LINDEN PARK (Linden)

One senior block, three 16m pitches (J1, J2, J3), one artificial pitch (A1), one 18m pitch (J4)

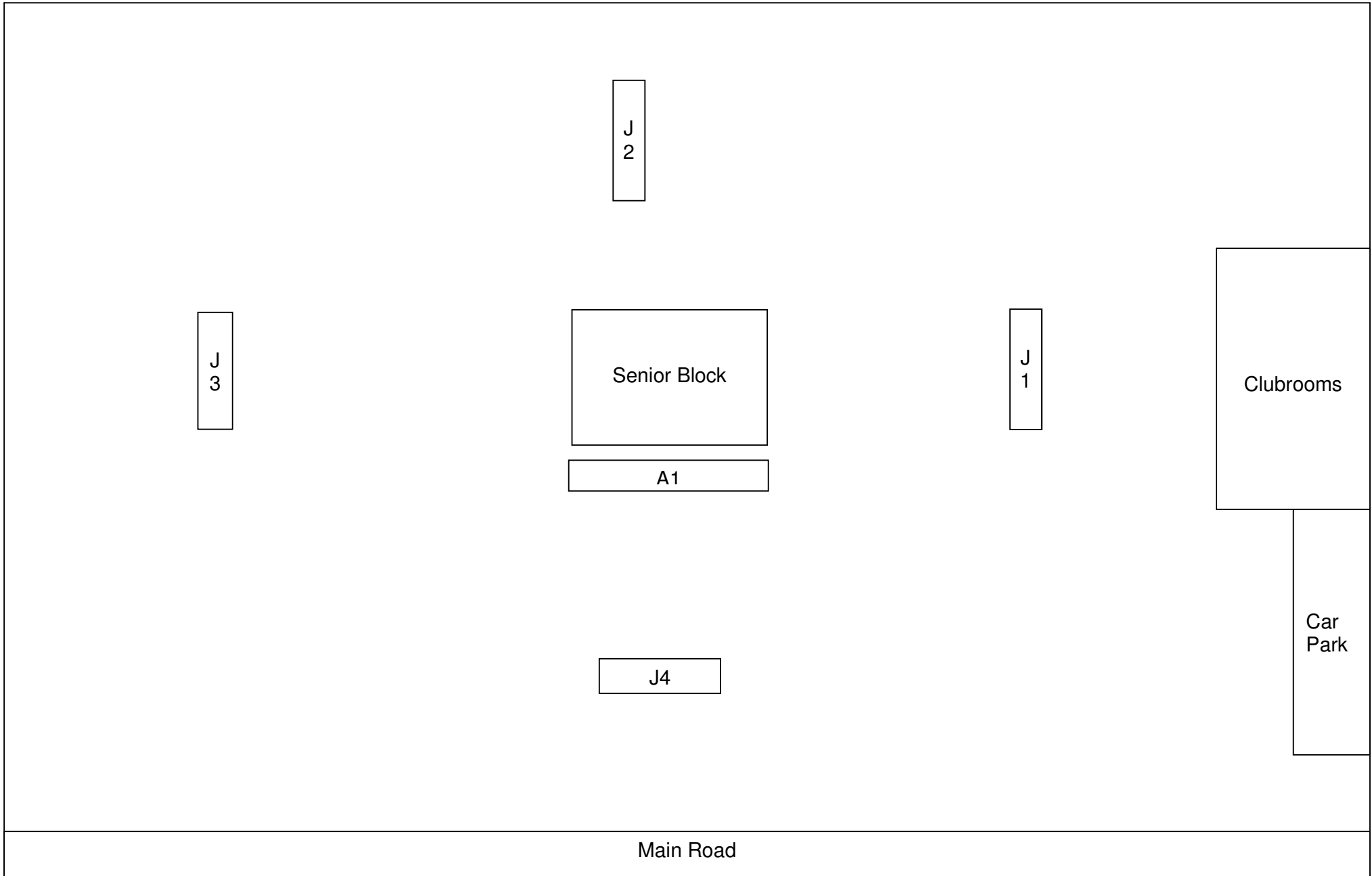

LINDEN WEST PARK (Linden)
One artificial pitch (A1)

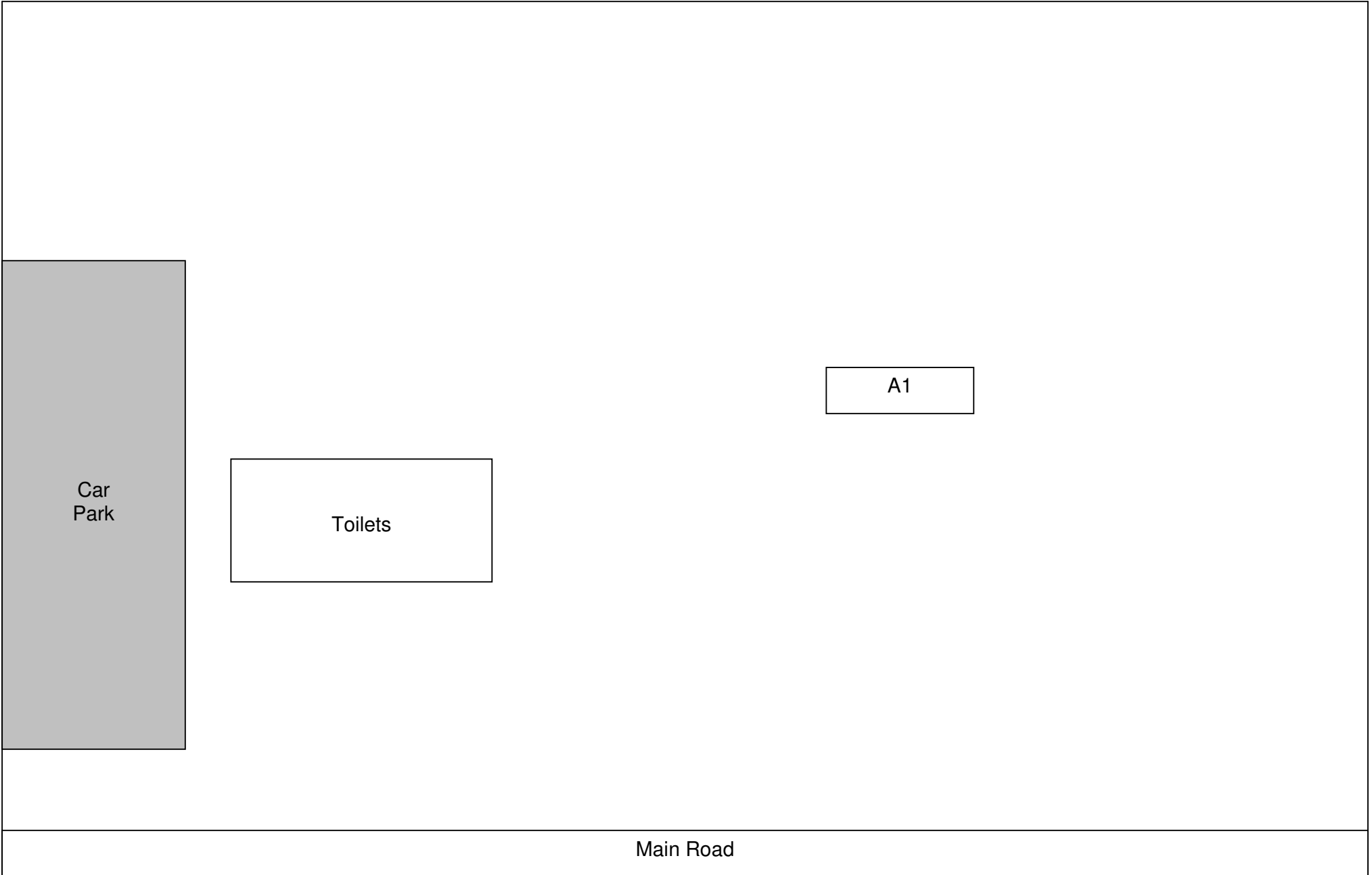

Car
Park

Toilets

A1

Main Road

MACALISTER PARK (Berhampore)

Four senior blocks, three full-length pitches (J1, J3, J4), one 16m pitch (J2)

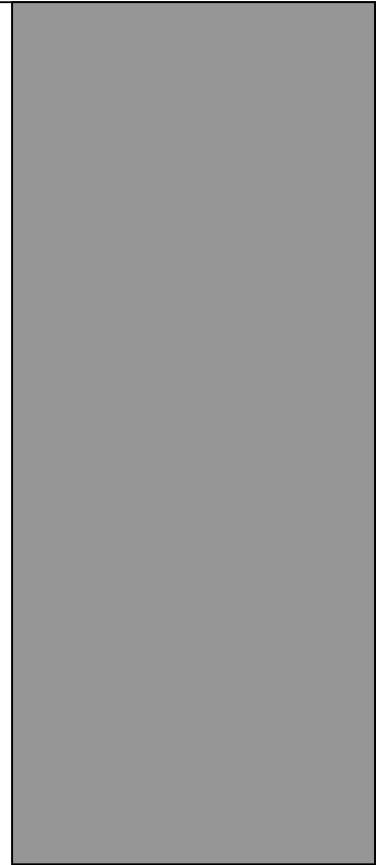
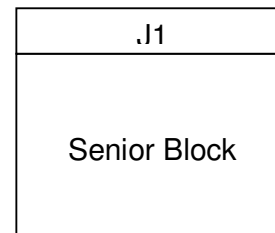
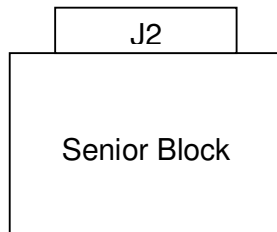
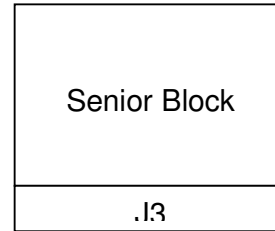
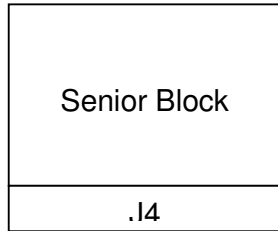

Adelaide Road

MELROSE PARK (Melrose)

One artificial pitch (A1)

A1

Toilets

MIRAMAR PARK (Miramar)

Three senior blocks, four 18m pitches (J1, J2, J3, J4)

J
1

Senior
Block

J
2

Senior
Block

J
3

Senior
Block

J
4

Darlington Road

NAIRNVILLE PARK - Lower (Ngaio)

Two senior blocks, three 18m pitches (J1, J2, J3), four 16m pitches (J4, J5, J6, J7)

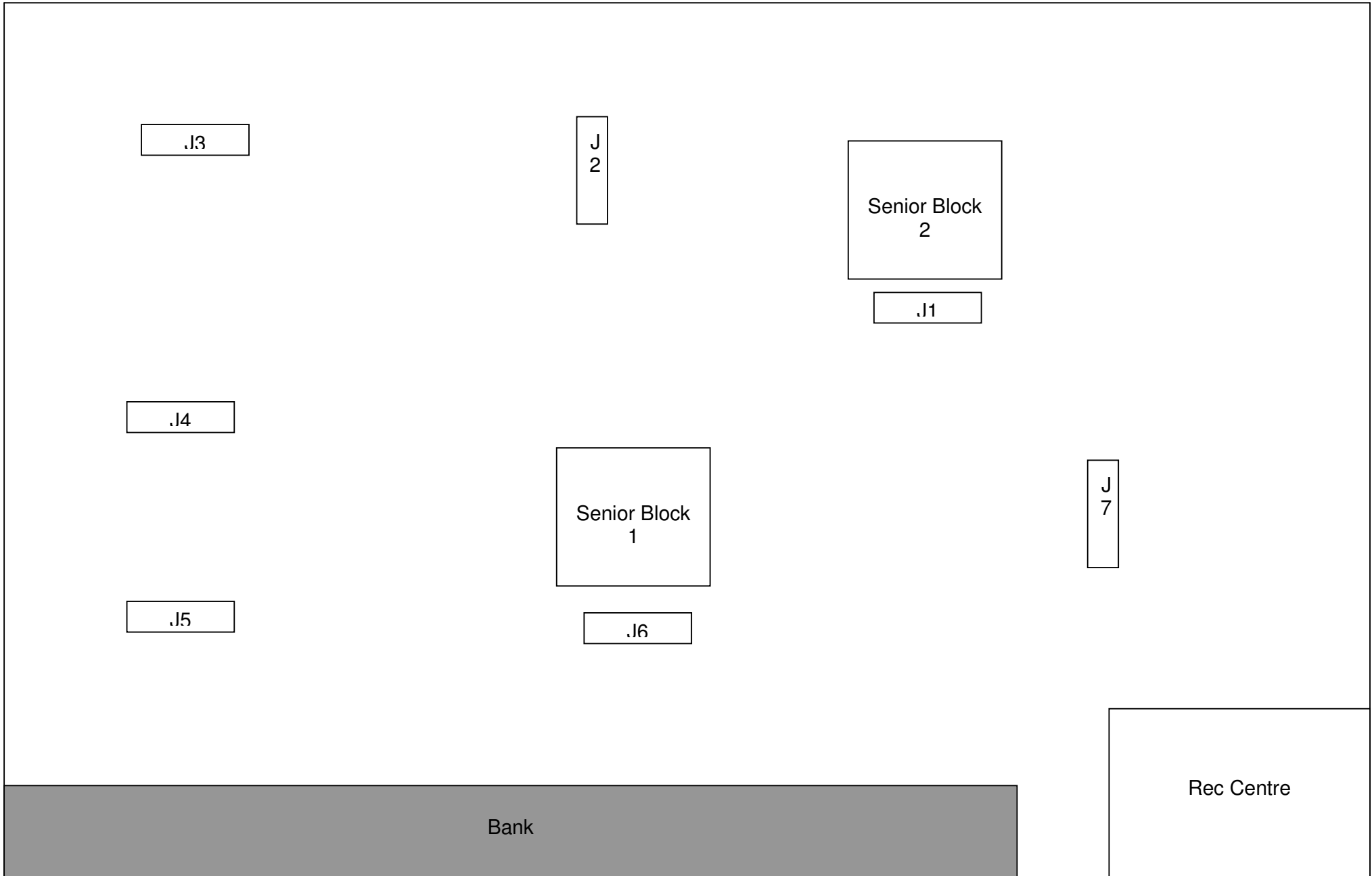

NEWLANDS PARK (Newlands)
One senior block, one artificial pitch (A1)

Toilets

Senior
1

A
1

PRINCE OF WALES PARK (Mt. Cook)

One senior block, one 18m pitch (J1)

Senior 1	J 1
-------------	--------

Toilets

TANERA PARK (Brooklyn)

One artificial pitch (A1)

A1

Toilets

SEATOUN PARK (Seatoun)

One senior block, one 18m pitch (J1), one 16m pitch (J2)

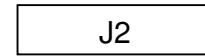
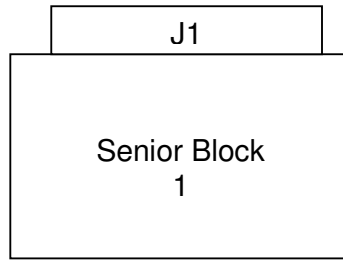

WAKEFIELD PARK (Berhampore)

Seven senior blocks, Four 18m pitches (J1, J2, J3, J4), three full-length pitches (J5, J6, J7)

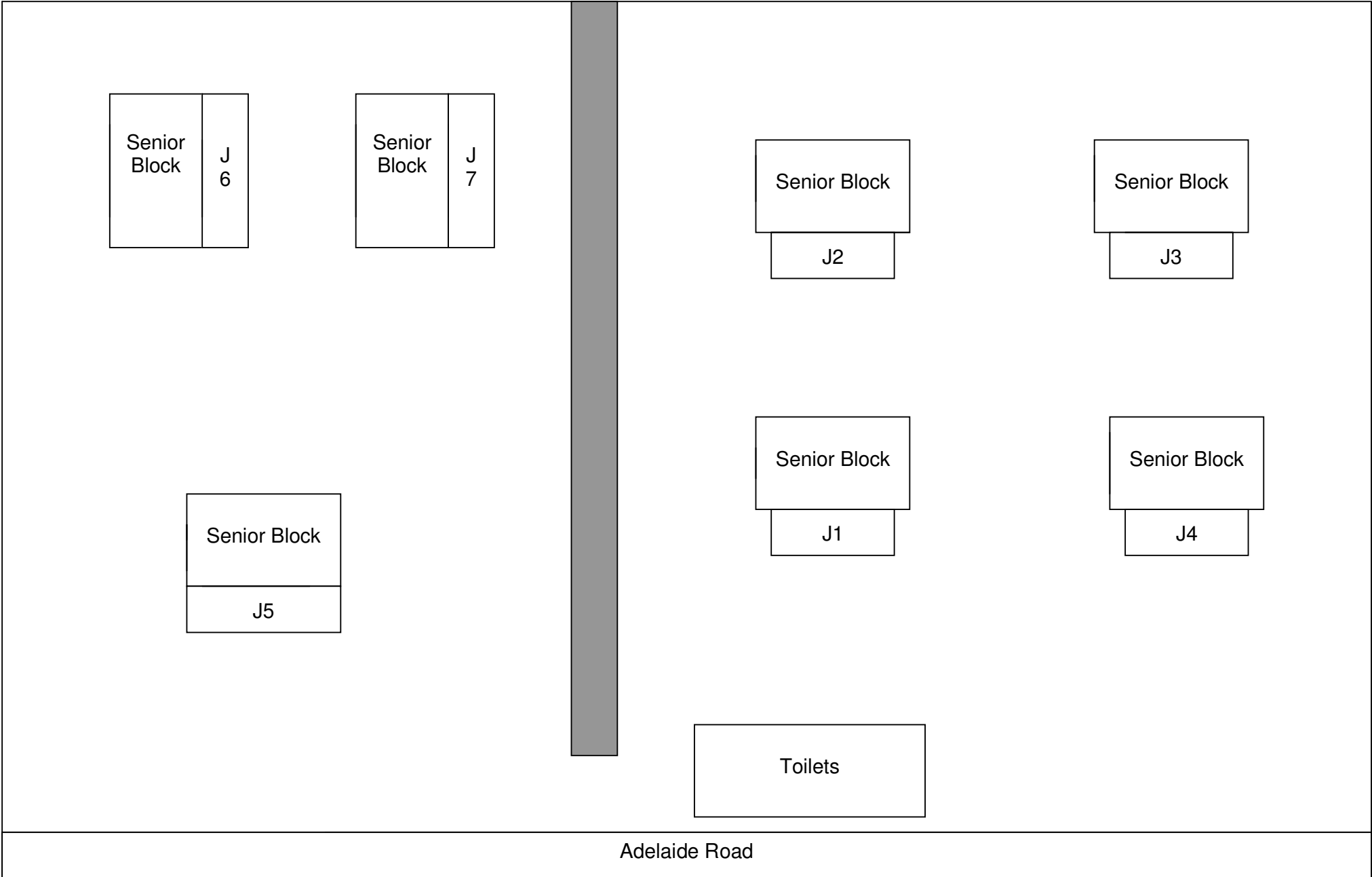

WILTON PARK (Wilton)
One artificial pitch (A1)

A1

Toilets

Path